

Promat



## CAFCO<sup>®</sup> Mesh Retaining Anchors



## CAFCO® Mesh Retaining Anchors

### INTRODUCTION

CAFCO® Mesh Retaining Anchor is a tested assembled item used to install CAFCO® Profiled Stainless Steel Mesh or CAFCO® Plastic Coated Galvanised Mesh for use with the Cafco FENDOLITE® MII system.

CAFCO® Mesh Retaining Anchor features a unique shouldered design to self align the anchor and mesh in order to avoid the mesh being pinched or cut during installation.

The anchors can be installed manually as shown below or in conjunction with an automatic feed system.

Properties and performance	
Dimensions and materials	Stainless steel 22.5mm with a 22mm leg
Installation	
Typical substrates	Concrete or blockwork
Methods	<p>CAFCO® Mesh Retaining Anchor is easily installed by placing the anchor in a drilled or precast 8mm hole of a minimum depth of 24mm and using a 4mm setting pin.</p> <p>This is used to displace the internal captive plug by up to 3mm, which will produce a pull out load in excess of 1.2KN in most concretes with consistent failure in base material.</p> <p>Supported by UKAS testing of pull out test in accordance with BS 1881-207: 1992.</p>

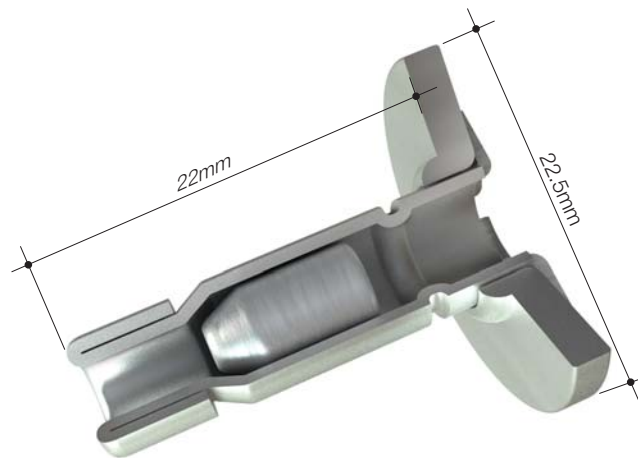

Before installation

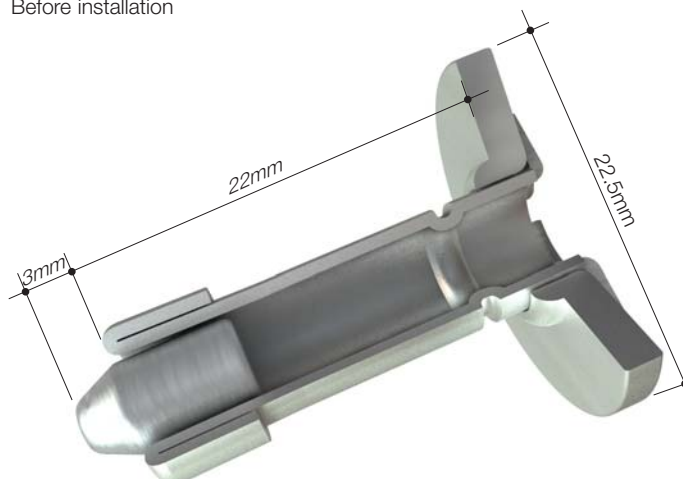

After installation



# CAFCO® Mesh Retaining Anchors

---

## PACKAGING

Boxes of 1,200.

## STORAGE

Off the ground and kept dry until ready for use.

## SHELF LIFE

No limit.

## QUALITY ASSURANCE

Promat manufactures to a quality system in accordance with ISO 9001:2000 and has received full accreditation to these standards.

Operating to these standards means that all activities, which have a bearing upon quality, are set out in written procedures. Systematic and thorough checks are made on all materials and their usage. Test equipment is subjected to regular checks and is referred back to national standards.

The information given in this data sheet is based on actual tests and is believed to be typical of the product. No guarantee of results is implied however, since conditions of use are beyond our control.

## HEALTH AND SAFETY

The use of eye protection and gloves is recommended. In addition, appropriate face masks should be used during any drilling operations.

Size and shape of the product would generally preclude ingestion. Medical attention should be sought in the event of parts being swallowed.

Normal hygiene precautions should be followed by washing hands before handling or eating food.

Promat activities are conducted with due regard to all statutory requirements with appropriate safeguards against exposing employees and the public to health and safety risks.

For latest information of the Promat Asia Pacific organisation, please refer to [www.promat-ap.com](http://www.promat-ap.com)

## ASIA PACIFIC HEADQUARTERS

**Promat International (Asia Pacific) Ltd.**  
Unit 19-02-01, Level 2 PNB Damansara  
No.19 Lorong Dungun, Damansara Heights  
50490 Kuala Lumpur  
MALAYSIA  
Tel: +60 (3) 2095 5111  
Fax: +60 (3) 2095 6111  
Email: [spraysinfo@promat-ap.com](mailto:spraysinfo@promat-ap.com)

## AUSTRALIA

**Promat Australia Pty. Ltd.**  
1 Scotland Road  
Mile End South, SA 5031  
Tel: 1800 PROMAT (776 628)  
Fax: +61 (8) 8352 1014  
Email: [spraysinfo@promat.com.au](mailto:spraysinfo@promat.com.au)

### New South Wales Office **Promat Australia Pty. Ltd.**

Unit 1, 175 Briens Road  
Northmead, NSW 2152  
Tel: 1800 PROMAT (776 628)  
Fax: +61 (2) 9630 0258  
Email: [spraysinfo@promat.com.au](mailto:spraysinfo@promat.com.au)

### Victoria Office

**Promat Australia Pty. Ltd.**  
3/273 Williamstown Road  
Port Melbourne, VIC 3207  
Tel: 1800 PROMAT (776 628)  
Fax: +61 (3) 9645 3844  
Email: [spraysinfo@promat.com.au](mailto:spraysinfo@promat.com.au)

### Queensland Office

**Promat Australia Pty. Ltd.**  
Unit 2 Level 1  
49 Gregory Tce  
Spring Hill, QLD 4000  
Tel: 1800 011 376  
Fax: 1800 334 598  
Email: [spraysinfo@promat.com.au](mailto:spraysinfo@promat.com.au)

## CHINA

**Promat China Ltd.**  
Room 503, Block B, Qi Lin Plaza  
13-35 Pan Fu Road  
510180 Guangzhou  
Tel: +86 (20) 8136 1167  
Fax: +86 (20) 8136 1372  
Email: [spraysinfo@promat-ap.com](mailto:spraysinfo@promat-ap.com)

### Beijing Office

**Promat North China**  
*(Division of Promat China Ltd.)*  
Room 1507 Building 5, SOHO Xiandaicheng  
No.88 Jianguo Road, Chaoyang District  
100022 Beijing  
Tel: +86 (10) 8589 1254  
Fax: +86 (10) 8589 2904  
Email: [spraysinfo@promat-ap.com](mailto:spraysinfo@promat-ap.com)

For Promat International groups worldwide:  
[www.promat-international.com](http://www.promat-international.com)

1. This document is produced on the basis of information and experience available at the time of preparation. Promat is constantly reviewing and updating all of its test data and reserves the right to change products and specifications without notice.
2. Promat is not responsible if recipients of fire test reports, assessments or literature incorrectly interpret said contents and use products based on those interpretations.

## HONG KONG

**Promat International (Asia Pacific) Ltd.**  
Room 1010, C.C. Wu Building  
302-308 Hennessy Road  
Wanchai  
Tel: +852 2836 3692  
Fax: +852 2834 4313  
Email: [spraysinfo@promat-ap.com](mailto:spraysinfo@promat-ap.com)

## INDIA

**Promat International (Asia Pacific) Ltd.**  
*(India Representative Office)*  
610-611, Ansal Imperial Tower  
C-Block, Community Centre  
Naraina Vihar, Naraina  
110028 New Delhi  
Tel: +91 (11) 2577 8413  
Fax: +91 (11) 2577 8414  
Email: [spraysinfo@promat-ap.com](mailto:spraysinfo@promat-ap.com)

### Bangalore Office

**Promat International (Asia Pacific) Ltd.**  
*(India Representative Office)*  
Cabin No.BC-9 & BC-10  
Oculus Workspaces, No.66/1, 2nd Floor  
Coles Road, Frazer Town  
560005 Bangalore  
Tel: +91 (80) 4031 4151  
Fax: +91 (80) 4125 2135  
Email: [spraysinfo@promat-ap.com](mailto:spraysinfo@promat-ap.com)

### Mumbai Office

**Promat International (Asia Pacific) Ltd.**  
*(India Representative Office)*  
Stylus Serviced Offices  
Ground Floor, Velocity  
Phase 1, Logitech Park  
Andheri Kurla Road, Andheri East  
400072 Mumbai  
Tel: +91 (22) 6769 4567  
Fax: +91 (22) 6769 4568  
Email: [spraysinfo@promat-ap.com](mailto:spraysinfo@promat-ap.com)

## MALAYSIA

**Promat (Malaysia) Sdn. Bhd.**  
Unit 19-02-01, Level 2 PNB Damansara  
No.19 Lorong Dungun, Damansara Heights  
50490 Kuala Lumpur  
Tel: +60 (3) 2095 8555  
Fax: +60 (3) 2095 2111  
Email: [spraysinfo@promat-ap.com](mailto:spraysinfo@promat-ap.com)

## SINGAPORE

**Promat Building System Pte. Ltd.**  
10 Science Park Road, #03-14 The Alpha,  
Singapore Science Park II  
Singapore 117684  
Tel: +65 6776 7635  
Fax: +65 6776 7624  
Email: [spraysinfo@promat-ap.com](mailto:spraysinfo@promat-ap.com)

Your local Promat supplier

